



ANIMA

ANIMA

Tech Rider

Updated 04.03.2022



Maëlle Poesy and Noémie Goudal

Work currently in rehearsal, first performance in early July at the Rencontres de la photographie-Arles festival

Concept : Noémie Goudal and Maëlle Poesy
Set Designer : Hélène Jourdan
Lighting Designer : Mathilde Chamoux
Sound composition : DJ Chloé
Suspension performance : Chloé Moglia
General Stage Manager : Géraud Breton
Video/lighting Operator : Pierre Mallaisé
Sound Operator : Sam Babouillard
Set Builder : Ateliers Eclectik Scéno (Dijon) and 20.12 (Paris)

Contact details and general information	P.2
Scheduling.....	P.3
Staging.....	P.4
Stage.....	P.5
Lighting.....	P.6
Sound.....	P.6
Video.....	P.7
Costumes.....	P.7
Annexes.....	P.8



ANIMA

CONTACTS

Stage Manager TdB : Bertrand Fournier – 03 80 68 47 31
Technical Assistant : Hélène Bourguignon – 03 80 68 47 87

Technical team on tour

Production	Miléna Noirot	07 77 81 00 89	m.noirot@tdb-cdn.com
General Stage Manager	Géraud Breton	06 32 25 44 72	geraubretelle@gmail.com
	Julien Poupon	06 30 35 29 41	julienpoupon@yahoo.fr
Video /Lighting Operator	Pierre Malaisé	06 04 67 23 35	mallaise.regie@gmail.com
Sound Operator	Sam Babouillard	06 27 70 47 67	sambabouillard@yahoo.fr

GENERAL INFORMATION

**This tech rider is intended for use in outdoor or non-theatre venues.
A separate rider is available for performances in performing arts venues.**

Technical team on tour : 1 acrobat, 3 technicians, 1 director, 1 production coordinator, 1 driver

Set transportation : 1 articulated lorry, with 80 m3 storage capacity

Estimated running time : 1h

Minimum required dimensions : 21x20 m
These dimensions include a seating capacity of around 200 people

Level ground, with no slope

**The audience is seated on cushions or benches. Tiered seating is necessary to ensure visibility.
Around 30 people on cushions and 170 places in the tiered seating**

Minimum temperature of 15°C

The feasibility of the installation following a technical visit by our team.



ANIMA

Amongst the different elements to be verified will be the following : nature and flatness of the ground, lighting interferences, access, etc.
Propositions for the setting-up of the show will be dependent on this visit, in addition to the planning and corresponding personnel requirements.

PERSONNEL REQUIREMENTS

This planning is provisional and subject to change in response to the specificities of the host venue.

NB: the assembly of the structures is physically demanding and requires personnel with the ability to work at height. Please take note of this in the composition of the technical team

(SM= Stage Manager, SH= Stagehand, LO= Lighting operator, E= Electrician, VO= Video Operator, SO= Sound Operator, D= Dresser)

Assembly Day-1 :

	SM	SH	LO	E	VO	SO	D	
09h-13h	1	6	0	0	1	0	1	Unloading, assembly of structures, video installation
14h-18h	1	6	1	2	1	1		Continuation of structures assembly, lighting, video, sound
20-23h	1	6	1	2	1	1		End of structures assembly, lighting adjustment , video, sound

1st performance day : (show at 20h)

	SM	SH	LO	E	VO	SO	D	
09h-13h	1		1	1	1	1		Final installation adjustments
14h-16h	1		1		1	1		Technical run-through
16h-18h30	1		1		1	1		Stage setting, sound/video/lighting checks, warm up
19h30-20h	1		1		1	1		Audience entry
20h-21h	1		1		1	1		Performance 1
21h-23h	1	1						Post-show stage setting

X Performance(s) : (show at 20h)

	SM	SH	LO	E	VO	SO	D	
09h-13h							1	Costume maintenance
15h30-18h30	1		1		1	1		Stage setting, sound/video/lighting checks, warm up
19h30-20h	1		1		1	1		Entry of audience
20h-21h	1		1		1	1		Performance
21h-23h	1	1						Post-show stage setting

Disassembly (the day after the last performance)



ANIMA

	SM	SH	LO	E	VO	SO	D	
09h-13h	1	6	1	2	1	1	1	Disassembly
14h00-16h00	1	6						End of disassembly, loading



ANIMA



STAGE SET

-3 self-supporting structures, weighted. The 3 structures need to be fixed to the ground.

-These structures measure 6x5.3m, and each houses one or several video projector supports measuring 6x4.80m.

Combined weight of structures : 600 kg

Structure 1 :

- A white projection screen that is retractable from above. Manually operated.
- Beneath the fabric of the screen is an imprint on water-soluble paper glued to a perforated tarpaulin.
- This paper decomposes via contact with water, supplied by nozzles positioned behind the tarpaulin.
- The water is recuperated by a duct, the pieces of soggy paper fall to the ground.

Structure 2 :

- A white projection screen that is retractable from above, via manual control.
- This structure incorporates circus apparatus for the performance of Chloé Moglia.
- For security reasons, it is imperative that the different parts of this structure be handled with the utmost care.

Structure 3 :

- A white projection screen
- A fourth self-supporting structure is present behind the spectators. It houses the backstage area, lighting clamps and 3 video projectors.
- The lighting is incorporated in our set



ANIMA

STAGE

TECHNICAL REQUIREMENTS

A storage area is necessary for the video projectors for outdoor performances.

Material to be provided by the venue

- The ground may need to be covered with a carpet
- Ballast for the structures VP stands (type and quantity to be defined)
Currently, 1800 kg of ballast per structure. Exact amount awaiting confirmation by technical experts
- A water outlet in proximity to the stage, 4 bars of pressure, flow of 16 l/min minimum
- 2 moving scaffolding towers, working height of 6m

Material provided by us

- The 3 structures described above
- The structure for the backstage area/lighting/VPs
- Tank and water pump for supplying the nozzles
- 80 cushions spread across the ground (round cushions, 40x18 cm)
- 10 four-person benches, length 200cm, height 30 and 45 cm



ANIMA

LIGHTING

Material to be provided by the venue

PROJECTORS

POWER

Electricity supply of ?? kW

CABLING

16 A extension leads, ??m

DISPOSABLES

Material we provide

SPECIAL EFFECTS

FILTERS

TECHNICAL REQUIREMENTS

SOUND

Material to be provided by the venue

BROADCAST

MICROPHONES

Material we provide

TECHNICAL REQUIREMENTS



ANIMA

VIDEO

Material to be provided by the venue

3 WUXGA 10000 Lumens video projectors. Lenses to be confirmed.
In order to ensure the quality of the show, it is imperative that the three VP be identical.

In order to simplify the organisation and reduce hire costs, we suggest mutualising resources for all our touring needs. It would be possible to invoice you for the VP at a preferential rate (cost on demand depending on the duration

Material we provide

1 Mac Book Pro

COSTUMES

COSTUME MAINTENANCE

TECHNICAL REQUIREMENTS

DRESSING ROOMS

We require one dressing room for one actress and a rest room for 3 technicians.

ANNEXES



ANIMA

- Model layout

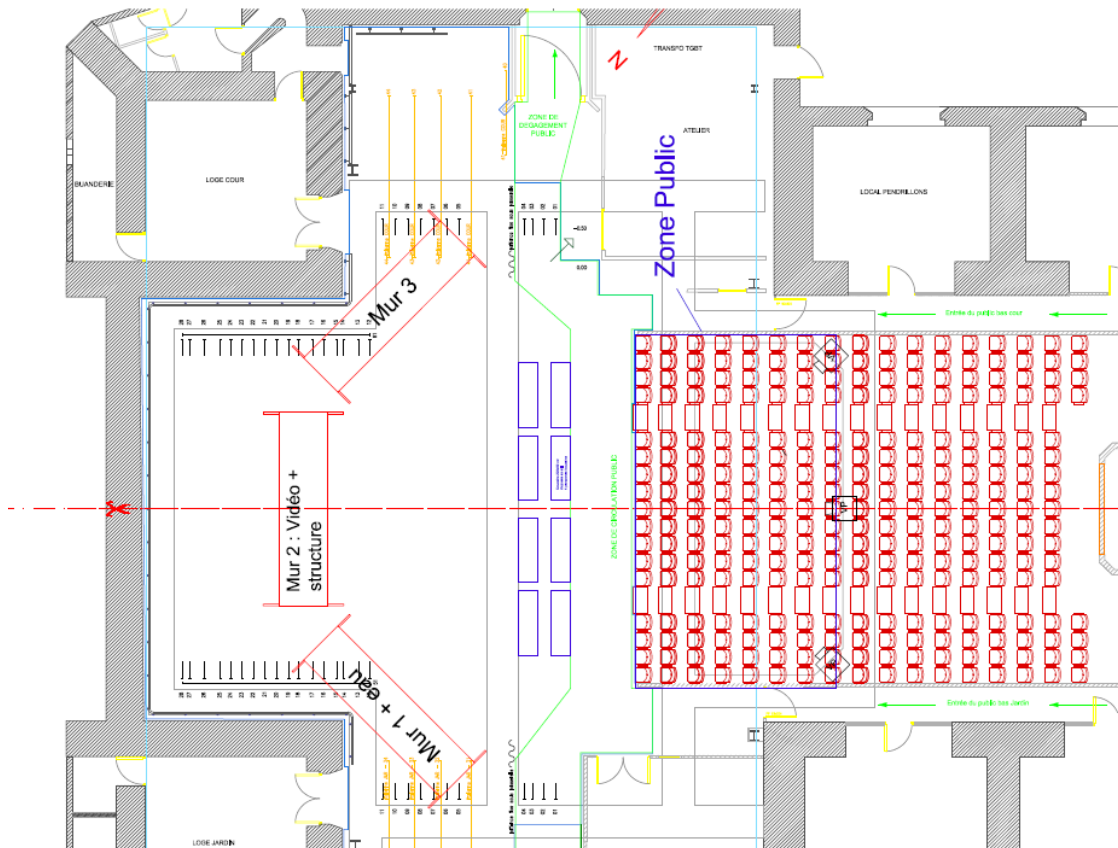

This technical rider is an integral part of the contract. Modifications may be made to it in accordance with the host venue's technical capabilities. Please contact us in advance in order to ascertain the feasibility of any proposed modifications, and to ensure that they do not hinder the performance of the show in any way.